

STARTING THE KIT

1. Open the laptop by pushing the grey button located on the top front of the laptop to the left.



Figure 8 - Opening the Laptop

The start button is located on the left side of the laptop

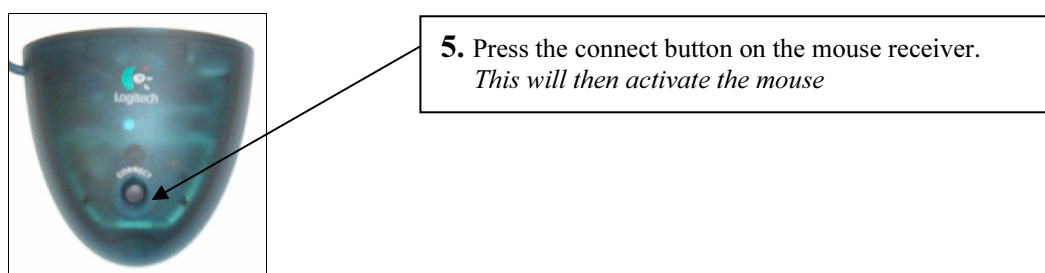
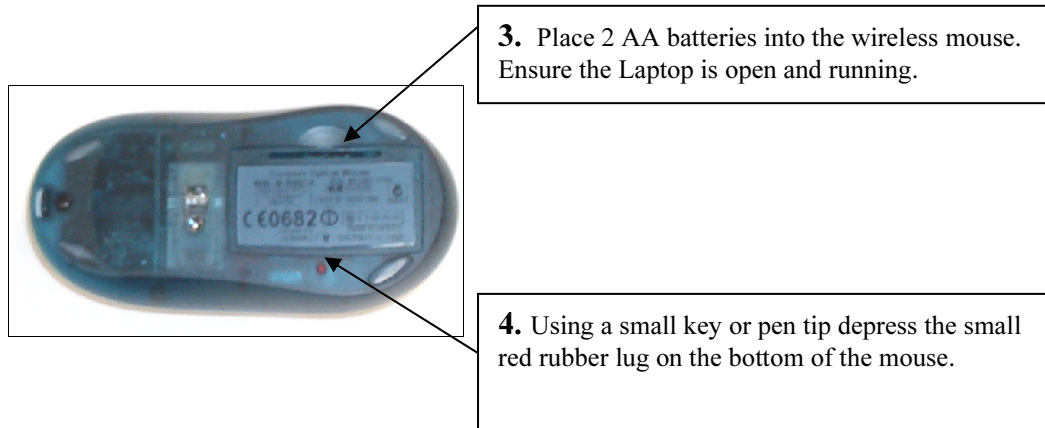
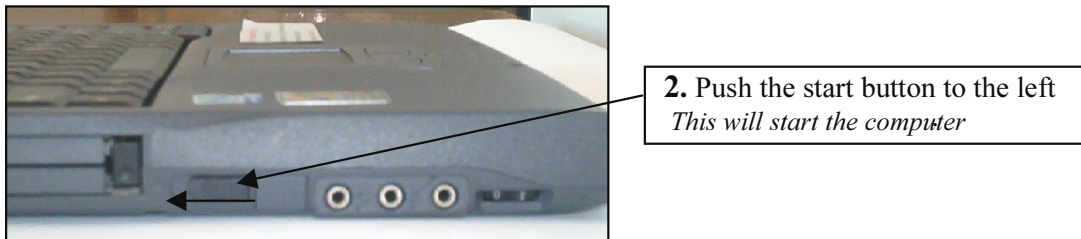

Figure -10 Activating the Mouse

LAUNCH AND FUNCTION KEYS

Launch Keys

The following launch keys have been programmed.

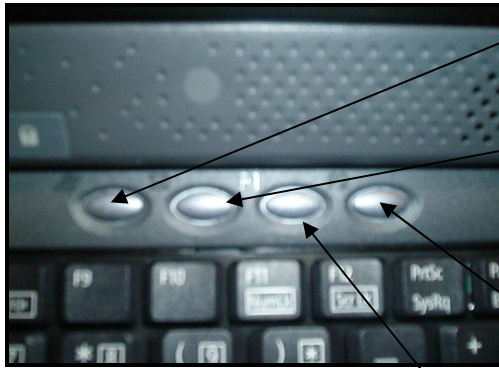

Figure 11 - ACER Launch Keys

PLANET Key: Launches CDMA Dial Up
Located above the F9 Key

✉ Key: Launches Compose Email box
Located above the F10 Key

**P2 Key: Launches IMS
(Incident Management System)**
Located above the F12 Key

P1 Key: Launches OZI Explorer Program
Located above F11 Key

Ozi Explorer Function keys

The following function keys have been programmed into Ozi Explorer.

Key	Function
F1	Standard Ozi Explorer Help key
F2	Moving Map - Show/Hide Moving map control
F3	View Show/Hide Track
F4	Moving Map - Start/Stop GPS (NMEA) Communication
F5	Options - Area Calculation
F6	View Show/Hide Track Control
F7	View Show/Hide Point Control
F8	Other - Find maps at Current position
F9	Options - Show/Hide Name Search
F10	Unassigned
F11	Unassigned
F 12	Other - Track 1 Quick Clear